

# South Carr School



Pre-School & ECSE

- Replace windows with energy efficient and larger windows
- Replace identified sections of roofing
- Replace boiler, piping, and classroom heating units
- Pre-School, Early Childhood Special Education, and Golden Eagles would stay in the building

# Impact on Homeowners

Impact on homeowners depends on the taxable value of their home.

Home Market Value	Home Taxable Value *	Yearly Increase	Monthly Increase	Weekly Increase
\$20,000	\$10,000	\$12.40	\$1.03	\$0.24
\$40,000	\$20,000	\$24.80	\$2.07	\$0.48
\$60,000	\$30,000	\$37.20	\$3.10	\$0.72
\$80,000	\$40,000	\$49.60	\$4.13	\$0.95
\$100,000	\$50,000	\$62.00	\$5.17	\$1.19
\$120,000	\$60,000	\$74.40	\$6.20	\$1.43
\$140,000	\$70,000	\$86.80	\$7.23	\$1.67

\* Taxable value is approximately half the market value of a home

# Revenue

The proposed millage rate increase of 1.24 mills would generate

**\$16,115,000**

About two-thirds of the revenue would add space for increasing student enrollment

# Bond Proposal 2019



For more details visit

[OakridgeSchools.org/Bond](http://OakridgeSchools.org/Bond)

# Lower Elementary

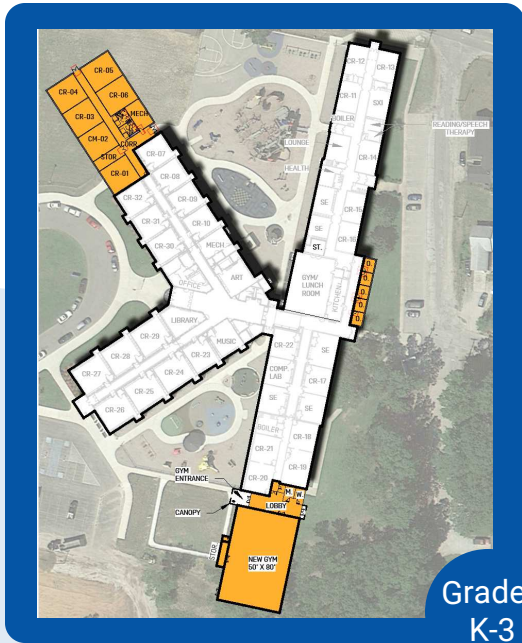

Grades  
K-3

- Add six classrooms
- Add elementary gymnasium
- Add space for small group student services like speech, social work, and special education
- Replace identified sections of roofing



# Upper Elementary

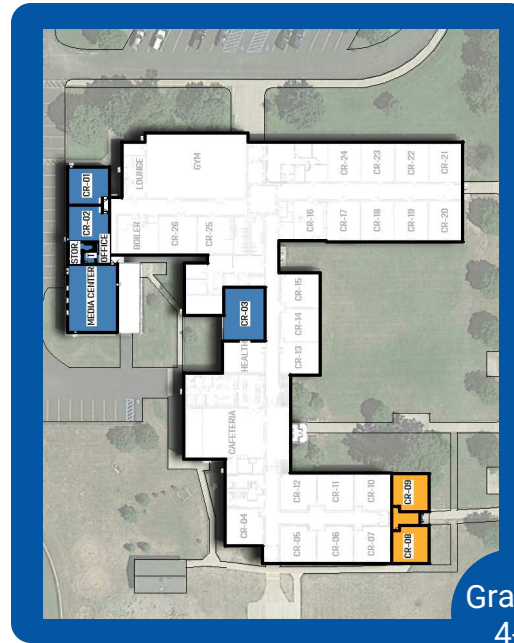

Grades  
4-6

- Add two classrooms
- Renovate two locker rooms into two classrooms
- Renovate old 'band/shop room' into a modern media center allowing the existing library to become a classroom
- Renovate spaces between locker rooms and new media center into spaces for small group services like speech, social work, and/or intervention
- Replace identified sections of roofing
- Replace identified classroom heating unit ventilators

# Middle/High School

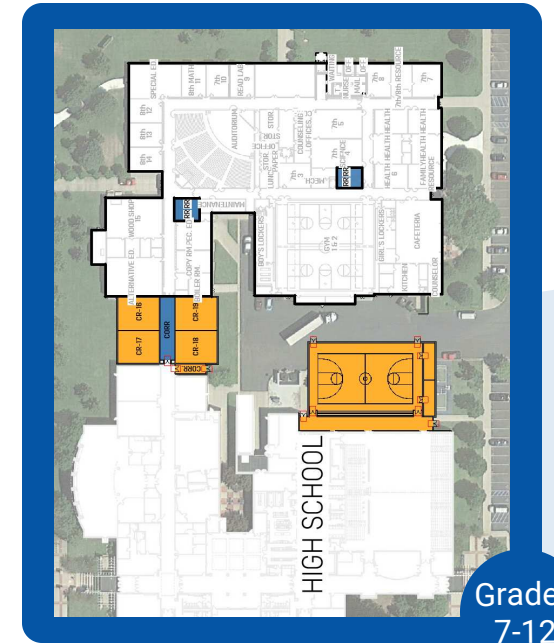

Grades  
7-12

- Add four classrooms between the buildings
- Add an auxiliary gym to the High School
- Renovate four student restrooms
- Renovate auditorium's stage area including ADA accessibility and electrical/lighting systems
- Replace identified sections of roofing
- Replace identified heating unit ventilators