

# VOTE ON NOVEMBER 5



Boiler Condition



Expanding Community



Library in Hallway



Roof Condition

## 2019 BOND PROPOSAL INFORMATION

### LOWER ELEMENTARY:

- Add six classrooms
- Add elementary gymnasium
- Add space for small group student services like speech, social work, and special education
- Replace identified sections of roofing

### UPPER ELEMENTARY:

- Add two classrooms
- Renovate two locker rooms into two classrooms
- Renovate old 'band/shop room' into a media center allowing the existing library to become a classroom
- Renovate spaces between locker rooms and new media center into spaces for small group services like speech, social work, and intervention
- Replace identified sections of roofing
- Replace identified classroom heating unit ventilators

### MIDDLE/HIGH SCHOOL CAMPUS:

- Add four classrooms between the buildings
- Add an auxiliary gym to the High School
- Renovate four student restrooms
- Renovate auditorium's stage area including ADA accessibility and electrical/lighting systems
- Replace identified sections of roofing
- Replace identified heating unit ventilators

### SOUTH CARR PRESCHOOL:

- Replace windows with larger and energy efficient windows
- Replace identified sections of roofing
- Replace boiler, piping, and classroom heating units

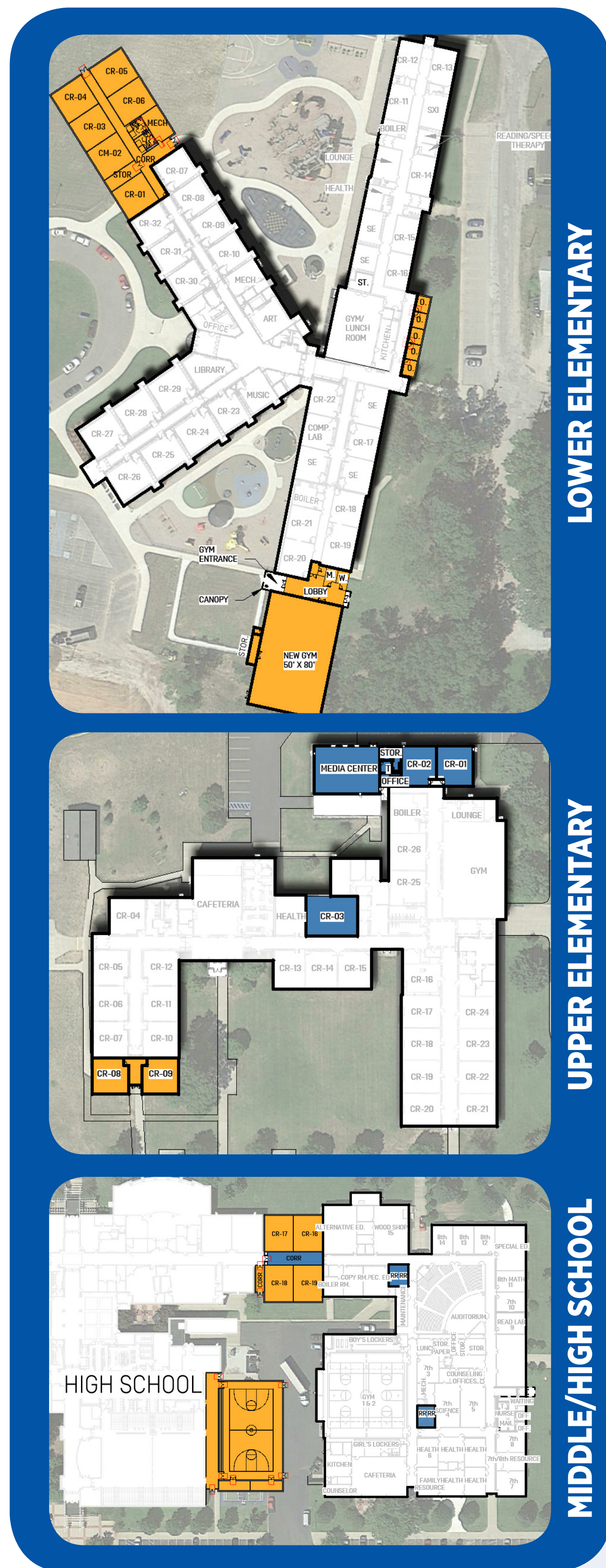

LOWER ELEMENTARY

UPPER ELEMENTARY

MIDDLE/HIGH SCHOOL

= NEW  
 = RENOVATED  
 = EXISTING

## IMPACT TO HOMEOWNERS

A property tax increase of 1.24 mils would raise **\$16,115,000** for improvements and additions.

\*taxable value is approximately half of the market value of a home.

HOME MARKET VALUE	HOME TAXABLE VALUE	YEARLY INCREASE	MONTHLY INCREASE	WEEKLY INCREASE
\$20,000	\$10,000	\$12.40	\$1.03	\$0.24
\$40,000	\$20,000	\$24.80	\$2.07	\$0.48
\$60,000	\$30,000	\$37.20	\$3.10	\$0.72
\$80,000	\$40,000	\$49.60	\$4.13	\$0.95
\$100,000	\$50,000	\$62.00	\$5.17	\$1.19
\$120,000	\$60,000	\$74.40	\$6.20	\$1.43
\$140,000	\$70,000	\$86.80	\$7.23	\$1.67



For more details visit [www.OakridgeSchools.org/Bond](http://www.OakridgeSchools.org/Bond)