

South Carr School



Pre-School & ECSE

- Replace windows with energy efficient and larger windows
- Replace identified sections of roofing
- Replace boiler, piping, and classroom heating units
- Pre-School, Early Childhood Special Education, and Golden Eagles would stay in the building

Impact on Homeowners

Impact on homeowners depends on the taxable value of their home.

Home Market Value	Home Taxable Value *	Yearly Increase	Monthly Increase	Weekly Increase
\$20,000	\$10,000	\$12.40	\$1.03	\$0.24
\$40,000	\$20,000	\$24.80	\$2.07	\$0.48
\$60,000	\$30,000	\$37.20	\$3.10	\$0.72
\$80,000	\$40,000	\$49.60	\$4.13	\$0.95
\$100,000	\$50,000	\$62.00	\$5.17	\$1.19
\$120,000	\$60,000	\$74.40	\$6.20	\$1.43
\$140,000	\$70,000	\$86.80	\$7.23	\$1.67

* Taxable value is approximately half the market value of a home

Revenue

The proposed millage rate increase of 1.24 mills would generate

\$16,115,000

About two-thirds of the revenue would add space for increasing student enrollment



Bond Proposal 2019



For more details visit

OakridgeSchools.org/Bond

Lower Elementary

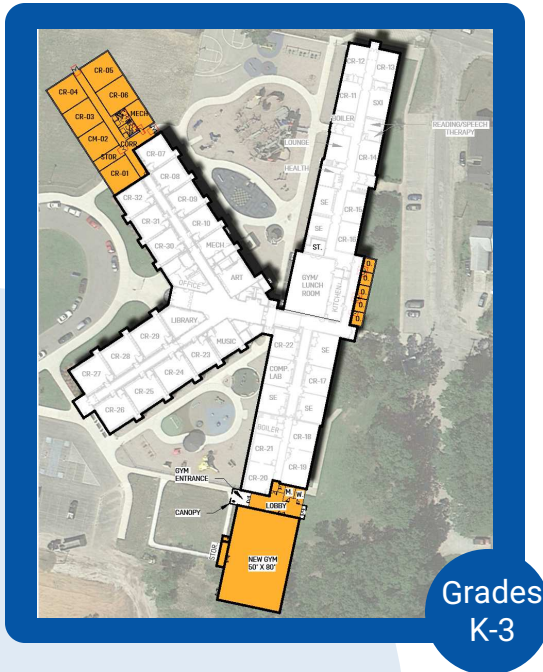

- Add six classrooms
- Add elementary gymnasium
- Add space for small group student services like speech, social work, and special education
- Replace identified sections of roofing



Upper Elementary

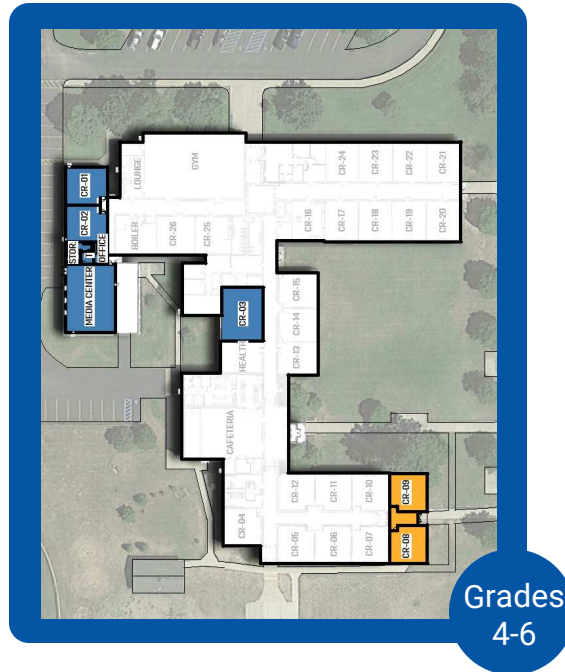

- Add two classrooms
- Renovate two locker rooms into two classrooms
- Renovate old 'band/shop room' into a modern media center allowing the existing library to become a classroom
- Renovate spaces between locker rooms and new media center into spaces for small group services like speech, social work, and/or intervention
- Replace identified sections of roofing
- Replace identified classroom heating unit ventilators

Middle/High School

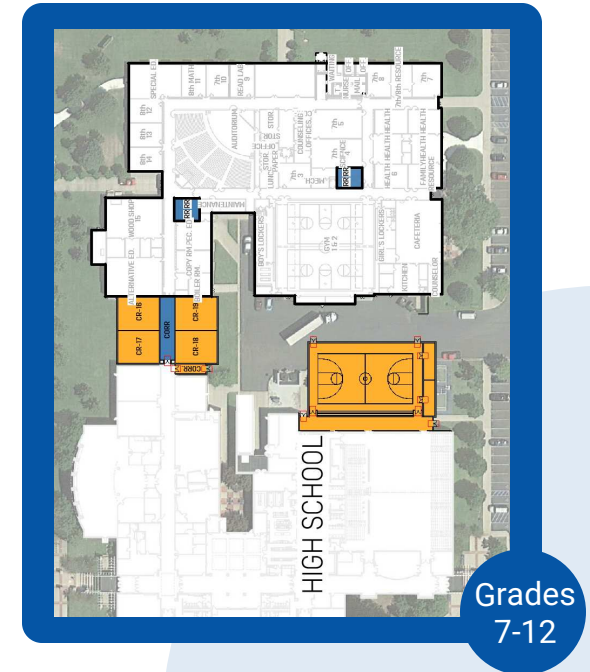

- Add four classrooms between the buildings
- Add an auxiliary gym to the High School
- Renovate four student restrooms
- Renovate auditorium's stage area including ADA accessibility and electrical/lighting systems
- Replace identified sections of roofing
- Replace identified heating unit ventilators